



SOUTHERN AFRICA'S PREMIER
AIR LOGISTICS PLATFORM

REFERENCE

Dube Cargo Terminal

King Shaka International Airport, Durban, South Africa

New Air Cargo Terminal with Tradezone Link

Automated ULD and Pallet Storage System

Customer:

Dube Tradeport Company
Durban, South Africa

Location:

King Shaka International Airport
Durban, South Africa

Year of Completion:

2010

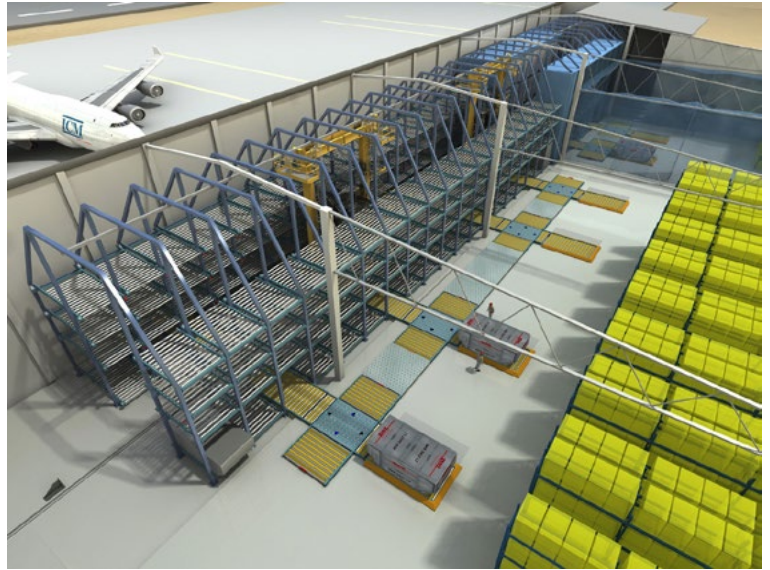

Equipment Details:



Automated ULD Cargo and Pallet Storage System including Cold storage (+ 1° C)
Express Cargo Sorting Facility

ULD Handling

- 2 15ft Elevating Transfer Vehicle
- 6 Elevating Workstations 10 ft
- 3 Workstations 15 ft
- Motor Powered Rollerdecks 10ft and 15ft
- 1 Cold Room with Workstation
- 2 Turn Table 15ft
- 202 Storage Conveyor Decks 10ft and 15 ft,
46 Units in Coldstorage (4 level)
- 2 Elevating Truck Docks
- 4 Ball Mat Areas

Steel Structure

Tradezone Link 310m

Euro-Pallet Storage

1584 Locations, High Bay Rack

Express and Courier Facility

250m sorting loop for 6 different
load/onload locations in Courier Facility
Roller Conveyor, 850mm width

5 X-Ray Units

X-Mover

Inventory Control System UniWare